

PLAN TOPOGRAFIC
SCARA 1/500

**P.U.D. CONSTRUIRE LOCUINTA, IMPREJMUIRE TEREN.
BRASOV. Str. Merilor f.nr.**

Judetul: Brasov
Unitatea administrativ-teritoriala: Brasov
Adresa: Brasov, F.N., Jud. Brasov
Cod SIRUTA: 40205
Cod SIRSUP: 40198

Numele si prenumele proprietarilor:
Fodorean Abel
Fodorean Antoaneta-Claudia
Adresa: Str. Nufurilor nr. 18, Codtea, Jud. Brasov

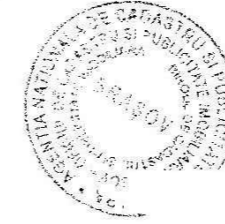

Prezentul document
receptionat este valabil insofit
de procesul verbal de receptie
nr. 27/2017 Data: 2.10.2017

Oficiul de Cadastru si Publicitate Imobiliara Brasov
Nr. de inreg. 11664 / data: 27.05.2017
Receptionat
ANDREEA VACARU
Semnatura: _____

- Legenda:**
- gard din plasa de sarma
 - gard cu fundatie de beton
 - gard din lemn
 - constructii invecinate
 - canal
 - gaz
 - hidrant
 - cutie electrica
 - stalp electric

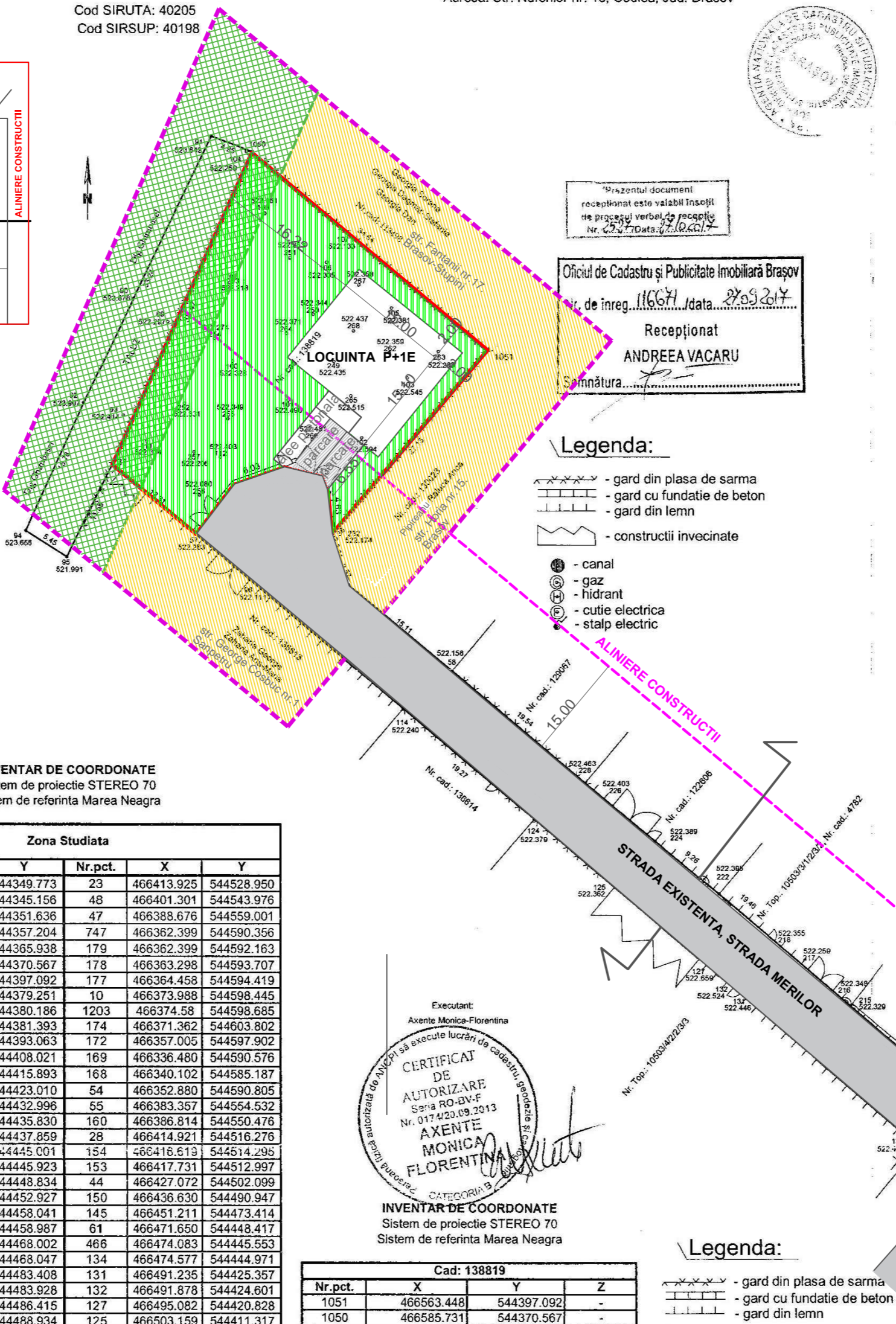
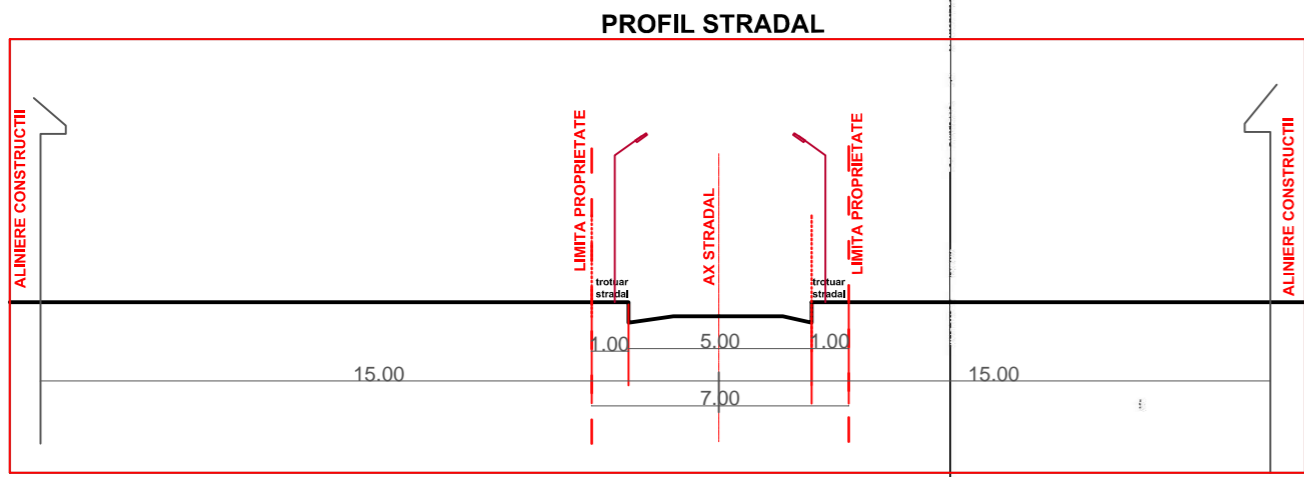

INVENTAR DE COORDONATE
Sistem de proiectie STEREO 70
Sistem de referinta Marea Neagra

Zona Studiata					
Nr.pct.	X	Y	Nr.pct.	Y	
95	466540.207	544349.773	23	466413.925	544528.950
94	466543.104	544345.156	48	466401.301	544543.976
92	466557.492	544351.636	47	466388.676	544559.001
90	466569.270	544357.204	747	466362.399	544590.356
91	466587.495	544365.938	179	466362.399	544592.163
1050	466585.731	544370.567	178	466363.298	544593.707
1051	466563.448	544397.092	177	466364.458	544594.419
70	466542.505	544379.251	10	466373.988	544598.445
71	466539.329	544380.186	1203	466374.58	544598.685
72	466537.057	544381.393	174	466371.362	544603.802
58	466527.452	544393.063	172	466357.005	544597.902
228	466514.884	544408.021	169	466336.480	544590.576
224	466508.329	544415.893	168	466340.102	544585.187
222	466502.403	544423.010	54	466352.880	544590.805
217	466493.944	544432.996	55	466383.357	544554.532
216	466491.544	544435.830	160	466386.814	544550.476
215	466489.825	544437.859	28	466414.921	544516.276
211	466483.748	544445.001	154	466416.613	544514.295
210	466482.964	544445.923	153	466417.731	544512.997
209	466480.486	544448.834	44	466427.072	544502.099
207	466477.004	544452.927	150	466436.630	544490.947
205	466472.738	544458.041	145	466451.211	544473.414
203	466471.948	544458.987	61	466471.850	544448.417
52	466464.427	544468.002	468	466474.083	544445.553
538	466464.391	544468.047	134	466474.577	544444.971
51	466452.021	544483.408	131	466491.235	544425.357
195	466451.581	544483.928	132	466491.878	544424.601
506	466449.472	544486.415	127	466495.082	544420.828
193	466447.338	544488.934	125	466503.159	544411.317
192	466446.699	544489.687	124	466510.819	544402.298
191	466442.383	544494.780	114	466523.200	544387.530
513	466439.493	544498.189	96	466537.642	544370.304
50	466439.373	544498.330	110	466540.603	544366.772
464	466439.012	544498.766	57	466542.727	544364.239
-	-	-	37	466550.637	544354.804

Suprafata studiata masurata = 3551 mp

Cad: 138819

Nr.pct.	X	Y	Z
1051	466563.448	544397.092	-
1050	466585.731	544370.567	-
37	466550.637	544354.804	-
57	466542.727	544364.239	522.283
237	466548.283	544368.505	522.407
236	466550.280	544374.196	-
115	466549.194	544378.400	-
233	466547.424	544379.214	522.284
232	466542.801	544379.489	522.174

Supraf. Calculata analitic=942 mp



INVENTAR DE COORDONATE
Sistem de proiectie STEREO 70
Sistem de referinta Marea Neagra

- Legenda:**
- gard din plasa de sarma
 - gard cu fundatie de beton
 - gard din lemn
 - constructii invecinate
 - canal
 - gaz
 - hidrant
 - cutie electrica
 - stalp electric

LEGENDA:

- LIMITA TERENURI INVECINATE
- LIMITA DE PROPRIETATE TEREN STUDIAT
- REGIM ALINIERE CONSTRUCTII
- TEREN STUDIAT, PROPRIETATEA PARTICULARA A PERSOANELOR FIZICE
- TERENURI INVECINATE PROPRIETATEA PARTICULARA A PERSOANELOR FIZICE
- STRADA EXISTENTA, STRADA MERILOR
- ZONA CIRCULATII INTERIOARE, PARCARI, ALEI
- ACCES AUTO IN INCINTA
- ACCES PIETONAL IN INCINTA
- ZONA PROTECTIE CANAL GHIMBASEL

BILANT TERITORIAL

FUNCTIUNILE	EXISTENT		PROPUS	
	M.P.	%	M.P.	%
ZONA CONSTRUCTII	-	0%	282	30%
TEREN INTRAVILAN CURTE GRADINA ZONA VERDE	942	100%	595	63,10%
ZONA CIRCULATII CIRCULATII PIETONALE CIRCULATII AUTO-PARCARE	-	0% 0%	15 50	1,60% 5,30%
TOTAL:	942	100%	942	100%

P.O.T. maxim = 30% = zona locuinte
C.U.T. maxim = 0,9.
Regim inaltime maxim = P+1E+M.
Regim inaltime propus = P+1E.

VERIFICATOR/EXPERT	NUME	SEMNTURA	CERINTA	REFERAT/EXPERTIZA NR./DATA	Nr. proiect: 68/2017
	SERBAN	SRL BRASOV		Denumire proiect: PUD - CONSTRUIRE LOCUINTA, IMPREJMUIRE TEREN Brasov, Str. Merilor f.nr.	Faza: P.U.D.
SPECIFICATIE	NUME	SEMNTURA	DATA:	Beneficiari: FODOREAN ABEL Jud. Brasov, Codtea, Str. Nufurilor nr.18.	Nr. planşa: U-05
SEF PROIECT:	ARHC. SERBAN GERAMIA		oct.2017.	Denumire planşa: PLAN SITUATIE -REGLEMENTARI URBANISTICE	
PROIECTANT:	ARHC. SERBAN GERAMIA		SCARA: 1:500		
NOTICII:	ARHC. SERBAN GERAMIA				