

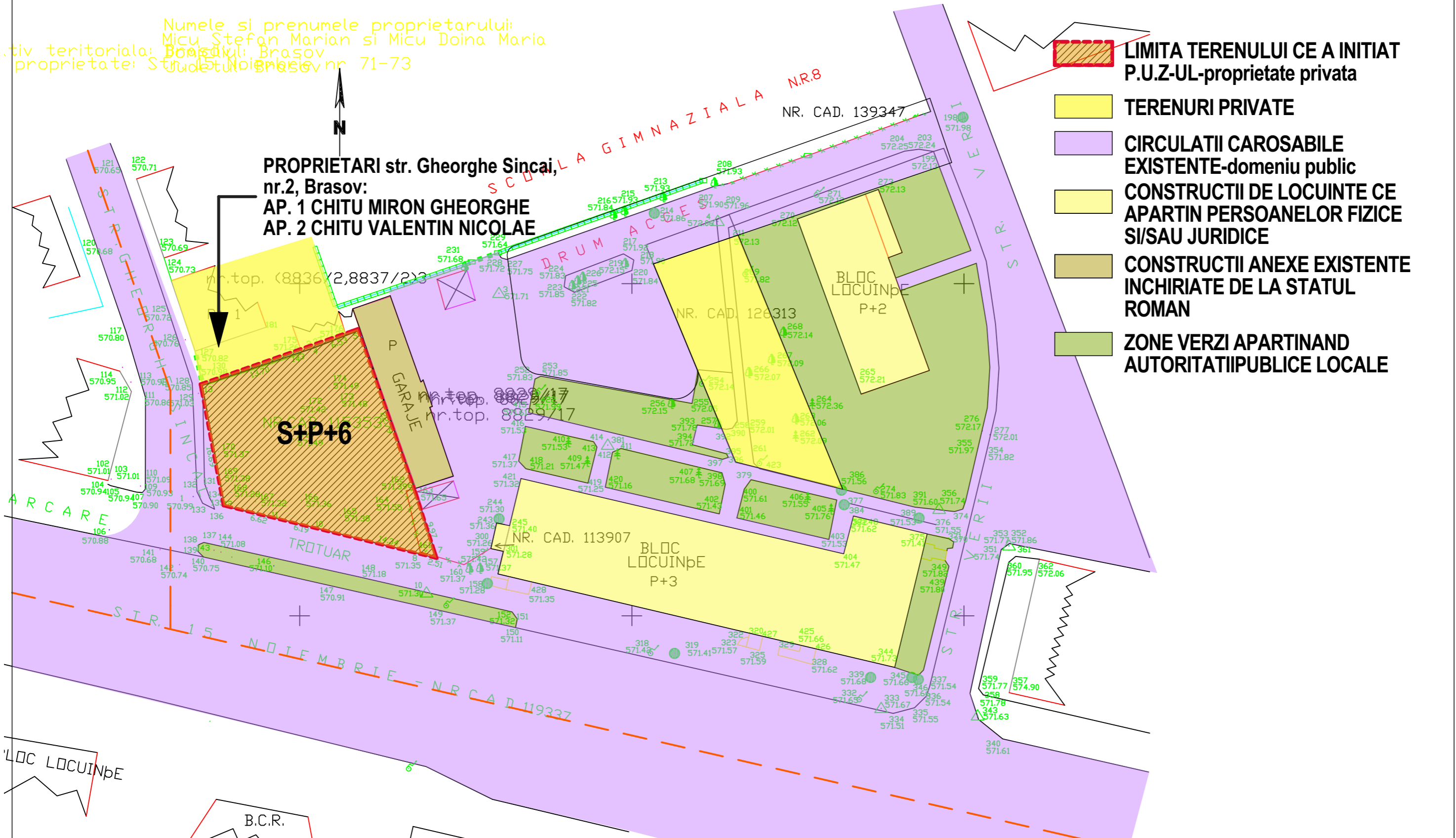





PLAN TOPOGRAFIC
SCARA 1/500

Numele si prenumele proprietarului:
Micu Stefan Marian si Micu Doina Maria
Activ teritoriala: Baza de date cadastrala
proprietate: Strada Noiebrsiev nr 71-73

PROPRIETARI str. Gheorghe Sincai,
nr.2, Brasov:
AP. 1 CHITU MIRON GHEORGHE
AP. 2 CHITU VALENTIN NICOLAE

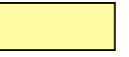

-  LIMITA TERENULUI CE A INITIAT P.U.Z-UL-proprietate privata
-  TERENURI PRIVATE
-  CIRCULATII CAROSABILE EXISTENTE-domeniu public
-  CONSTRUCTII DE LOCUINTE CE APARTIN PERSOANELOR FIZICE SI/SAU JURIDICE
-  CONSTRUCTII ANEXE EXISTENTE INCHIRIATE DE LA STATUL ROMAN
-  ZONE VERZI APARTINAND AUTORITATIIPUBLICE LOCALE

BLOC LOCUINBE

B.C.R.

BLOC LOCUINBE

<p>MGM urban proiect BRASOV, str.CARPATILOR, nr.44 j08/2894/2006</p>		<p>MODIFICARE PARTIALA PUZ APROBAT CU HCL 443/2009, PRELUNGIRE VALABILITATE APROBATA CU HCL 479/2012-modificare partiala trama stradala (zona strada Gheorghe Sincai-strada Verii)</p>	
		<p>beneficiar: MICU STEFAN MARIAN</p>	<p>proiect nr: 10.05.2017</p>
desenat	urb.Gabriela Micioiu	<p>IDENTIFICARE VECINATATI scara 1-500</p>	<p>PUZ U03'</p>
proiectat	urb.Gabriela Micioiu		
sef proiect	urb.Gabriela Micioiu		
<p>©COPYRIGHT! Acest proiect este proprietatea intelectuala a firmei MGM URBAN PROIECT .Instrainarea, multiplicarea sau folosirea cu alta destinatie decit cea prevazuta in contract a planselor sau soft-ului aferente intra sub incidenta legii dreptului de autor.</p>			