

PUD

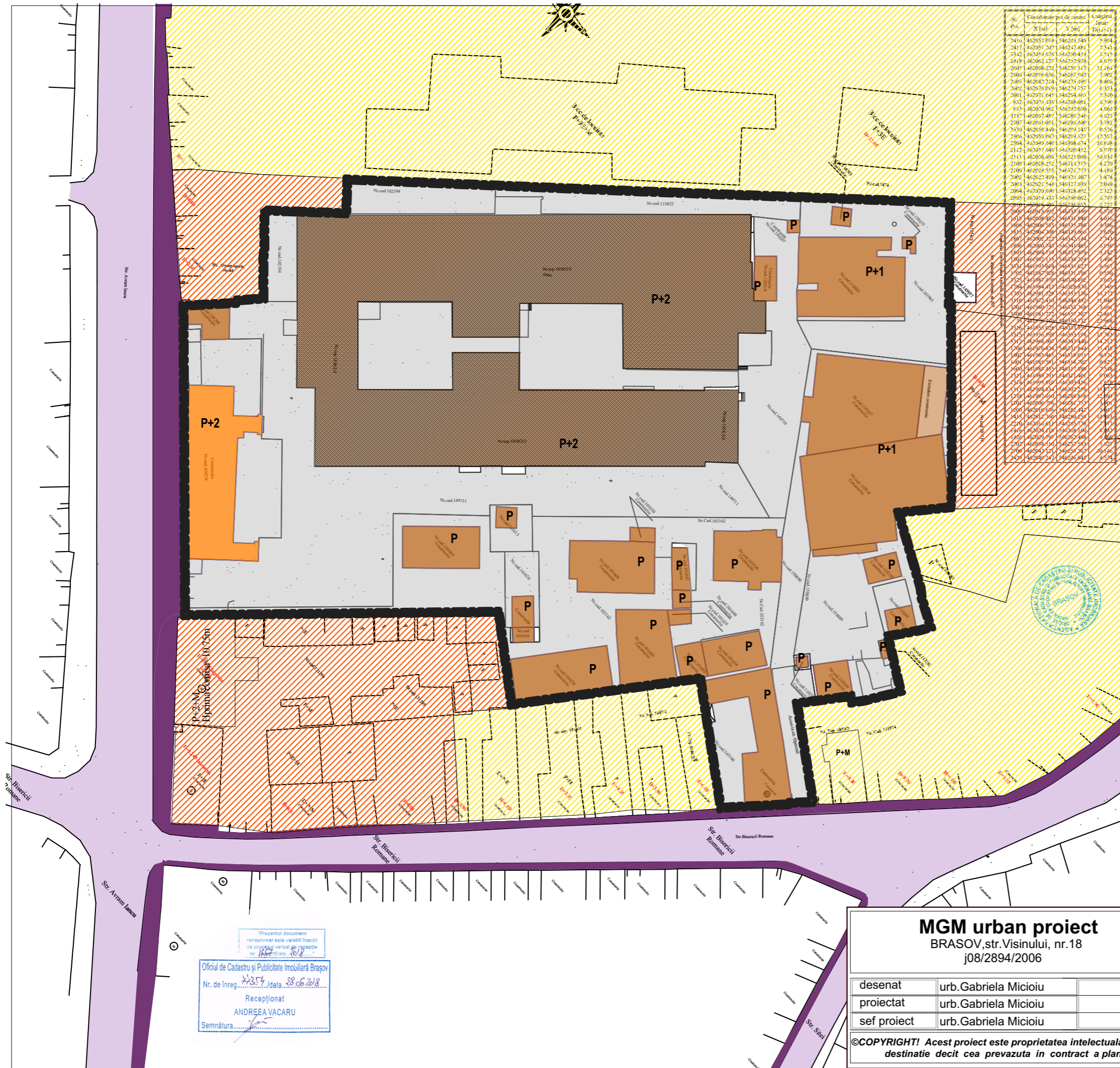

No.	Coordonate pe Lot, contine		Longit. (m)
	X (m)	Y (m)	
2416	462053.014	546203.540	5.994
2417	462053.207	546204.881	7.541
3342	462059.676	546200.419	5.515
2418	462062.177	546203.599	8.679
2409	462068.233	546201.174	12.654
2404	462016.676	546267.507	7.902
2405	462082.234	546275.499	8.806
2692	462076.019	546279.757	6.353
2691	462071.645	546294.565	5.310
653	462025.431	546208.081	5.769
653	462070.062	546292.600	4.864
4357	463007.487	546289.246	9.622
2307	462061.001	546295.800	3.782
2330	462058.449	546299.247	0.526
2504	462055.087	546291.227	2.587
2504	462049.040	546308.674	16.608
2112	462037.046	546304.452	9.970
2111	462016.898	546211.069	10.534
2109	462028.252	546311.375	8.278
2109	462024.555	546317.714	4.490
2002	462022.489	546325.407	18.78
2003	462021.544	546327.030	2.049
2004	462020.690	546328.802	2.127
2005	462019.435	546330.602	2.297
2006	462018.180	546332.424	2.472
1014	462008.482	546331.840	4.016
1009	462008.585	546325.288	4.506
1015	462004.208	546339.665	6.640
1016	462000.448	546341.085	7.854
1007	461994.109	546342.908	9.142
1001	461989.135	546346.249	1.008
1002	461989.043	546350.827	6.827
1003	461989.010	546355.405	11.652
1004	461989.010	546360.983	16.476
1005	461989.010	546366.561	21.300
1006	461989.010	546372.139	26.124
1007	461989.010	546377.717	30.948
1008	461989.010	546383.295	35.772
1257	461987.010	546383.295	12.008
1258	461987.010	546387.873	17.832
1259	461987.010	546392.451	23.656
1260	461987.010	546397.029	29.480
1261	461987.010	546402.607	35.304
1262	461987.010	546408.185	41.128
1263	461987.010	546413.763	46.952
1264	461987.010	546419.341	52.776
1265	461987.010	546424.919	58.600
1266	461987.010	546430.497	64.424
1267	461987.010	546436.075	70.248
1268	461987.010	546441.653	76.072
1269	461987.010	546447.231	81.896
1270	461987.010	546452.809	87.720
1271	461987.010	546458.387	93.544
1272	461987.010	546463.965	99.368
1273	461987.010	546469.543	105.192
1274	461987.010	546475.121	111.016
1275	461987.010	546480.699	116.840
1276	461987.010	546486.277	122.664
1277	461987.010	546491.855	128.488
1278	461987.010	546497.433	134.312
1279	461987.010	546503.011	140.136
1280	461987.010	546508.589	145.960
1281	461987.010	546514.167	151.784
1282	461987.010	546519.745	157.608
1283	461987.010	546525.323	163.432
1284	461987.010	546530.901	169.256
1285	461987.010	546536.479	175.080
1286	461987.010	546542.057	180.904
1287	461987.010	546547.635	186.728
1288	461987.010	546553.213	192.552
1289	461987.010	546558.791	198.376
1290	461987.010	546564.369	204.200
1291	461987.010	546569.947	210.024
1292	461987.010	546575.525	215.848
1293	461987.010	546581.103	221.672
1294	461987.010	546586.681	227.496
1295	461987.010	546592.259	233.320
1296	461987.010	546597.837	239.144
1297	461987.010	546603.415	244.968
1298	461987.010	546608.993	250.792
1299	461987.010	546614.571	256.616
1300	461987.010	546620.149	262.440
1301	461987.010	546625.727	268.264
1302	461987.010	546631.305	274.088
1303	461987.010	546636.883	279.912
1304	461987.010	546642.461	285.736
1305	461987.010	546648.039	291.560
1306	461987.010	546653.617	297.384
1307	461987.010	546659.195	303.208
1308	461987.010	546664.773	309.032
1309	461987.010	546670.351	314.856
1310	461987.010	546675.929	320.680
1311	461987.010	546681.507	326.504
1312	461987.010	546687.085	332.328
1313	461987.010	546692.663	338.152
1314	461987.010	546698.241	343.976
1315	461987.010	546703.819	349.800
1316	461987.010	546709.397	355.624
1317	461987.010	546714.975	361.448
1318	461987.010	546720.553	367.272
1319	461987.010	546726.131	373.096
1320	461987.010	546731.709	378.920
1321	461987.010	546737.287	384.744
1322	461987.010	546742.865	390.568
1323	461987.010	546748.443	396.392
1324	461987.010	546754.021	402.216
1325	461987.010	546759.599	408.040
1326	461987.010	546765.177	413.864
1327	461987.010	546770.755	419.688
1328	461987.010	546776.333	425.512
1329	461987.010	546781.911	431.336
1330	461987.010	546787.489	437.160
1331	461987.010	546793.067	442.984
1332	461987.010	546798.645	448.808
1333	461987.010	546804.223	454.632
1334	461987.010	546809.801	460.456
1335	461987.010	546815.379	466.280
1336	461987.010	546820.957	472.104
1337	461987.010	546826.535	477.928
1338	461987.010	546832.113	483.752
1339	461987.010	546837.691	489.576
1340	461987.010	546843.269	495.400
1341	461987.010	546848.847	501.224
1342	461987.010	546854.425	507.048
1343	461987.010	546860.003	512.872
1344	461987.010	546865.581	518.696
1345	461987.010	546871.159	524.520
1346	461987.010	546876.737	530.344
1347	461987.010	546882.315	536.168
1348	461987.010	546887.893	541.992
1349	461987.010	546893.471	547.816
1350	461987.010	546899.049	553.640
1351	461987.010	546904.627	559.464
1352	461987.010	546910.205	565.288
1353	461987.010	546915.783	571.112
1354	461987.010	546921.361	576.936
1355	461987.010	546926.939	582.760
1356	461987.010	546932.517	588.584
1357	461987.010	546938.095	594.408
1358	461987.010	546943.673	600.232
1359	461987.010	546949.251	606.056
1360	461987.010	546954.829	611.880
1361	461987.010	546960.407	617.704
1362	461987.010	546965.985	623.528
1363	461987.010	546971.563	629.352
1364	461987.010	546977.141	635.176
1365	461987.010	546982.719	641.000
1366	461987.010	546988.297	646.824
1367	461987.010	546993.875	652.648
1368	461987.010	546999.453	658.472
1369	461987.010	547005.031	664.296
1370	461987.010	547010.609	670.120
1371	461987.010	547016.187	675.944
1372	461987.010	547021.765	681.768
1373	461987.010	547027.343	687.592
1374	461987.010	547032.921	693.416
1375	461987.010	547038.499	699.240
1376	461987.010	547044.077	705.064
1377	461987.010	547049.655	710.888
1378	461987.010	547055.233	716.712
1379	461987.010	547060.811	722.536
1380	461987.010	547066.389	728.360
1381	461987.010	547071.967	734.184
1382	461987.010	547077.545	740.008
1383	461987.010	547083.123	745.832
1384	461987.010	547088.701	751.656
1385	461987.010	547094.279	757.480
1386	461987.010	547099.857	763.304
1387	461987.010	547105.435	769.128
1388	461987.010	547111.013	774.952
1389	461987.010	547116.591	780.776
1390	461987.010	547122.169	786.600
1391	461987.010	547127.747	792.424
1392	461987.010	547133.325	798.248
1393	461987.010	547138.903	804.072
1394	461987.010	547144.481	809.896
1395	461987.010	547150.059	815.720
1396	461987.010	547155.637	821.544
1397	461987.010	547161.215	827.368
1398	461987.010	547166.793	833.192
1399	461987.010	547172.371	839.016
1400	461987.010	547177.949	844.840

LEGENDA

- limita de proprietate-terenurile ce fac obiectul PUD
 - circulatii carosabile si pietonale publice
 - zone de locuinte existente
 - zona de servicii+comert, existente
 - cladiri industriale max. P+1, anexe-propuse pentru demolare
 - cladire de birouri ce se va pastra
 - cladire de birouri si alte destinatii - se va pastra
 - platforme betonate in incinta
- POT existent =50.62%
 CUT existent =1.46
 Regim de inaltime vecinatati: min. P, P+3+M, max. P+9+M

Bilant teritorial existent

	Suprafata	Procent
Fond construit	8028.00 mp	50.62%
ZOne verzi	0.00 mp	0.00%
Circulatii	7829.00mp	49.38%
Teren studiat	15857,00 mp	100,00 %

"Prezentul document
 negociat este valabil
 de la data de semnare
 la data 28.06.2018"

Oficiul de Cadastru și Publicitate Imobiliară Braşov
 Nr. de inreg. 43357 / data 28.06.2018
 Receptonat
 ANDREEA VACARU
 Semnatura

MGM urban proiect
 BRASOV, str. Visinului, nr. 18
 j08/2894/2006

Extindere imobil, schimbare de destinatie in spatii comerciale, birouri si locuinte. Construire imobile locuinte colective, birouri, spatii comerciale, amenajare parcauri- BRASOV, str. Avram Iancu, nr. 40-42 -
 beneficiar: **DÉCENT REAL ESTATE S.R.L. pentru**
PKC Real Estate Investments S.R.L. proiect nr. 05/2018

desenat	urb.Gabriela Micioiu
proiectat	urb.Gabriela Micioiu
sef proiect	urb.Gabriela Micioiu

PLAN DE SITUATIE EXISTENT
 SCARA 1-500

PUD **U03**

©COPYRIGHT! Acest proiect este proprietatea intelectuala a firmei MGM URBAN PROIECT .Instrainarea, multiplicarea sau folosirea cu alta destinatie decit cea prevazuta in contract a planselor sau soft-ului aferente intra sub incidenta legii dreptului de autor.